

OMEGA 10 PANEL ON SQUARE POST

PANEL 4' (44 lb/ 20 kg)

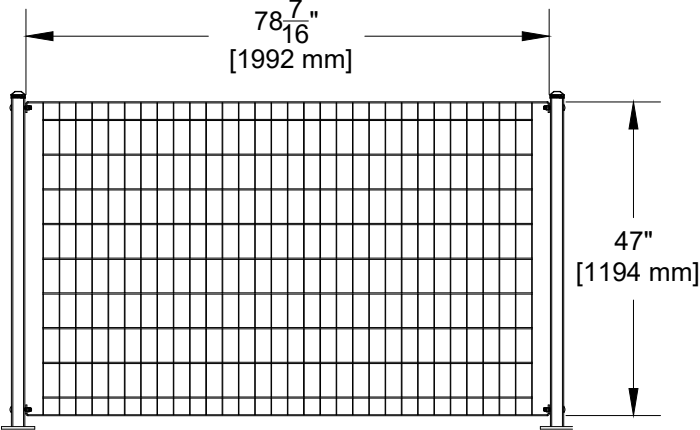

PANEL 8' (85 lb/ 38.6 kg)

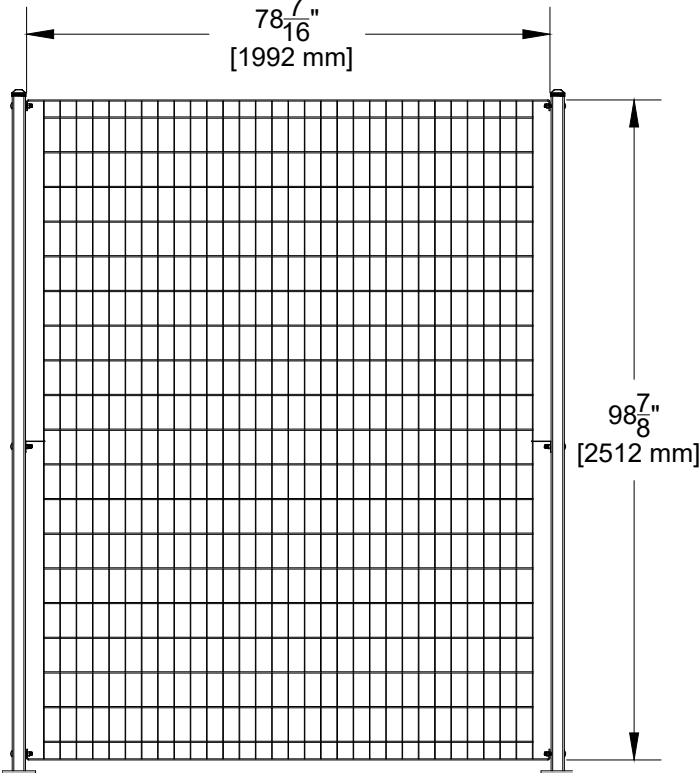

PANEL 6' (68 lb/ 30.8 kg)

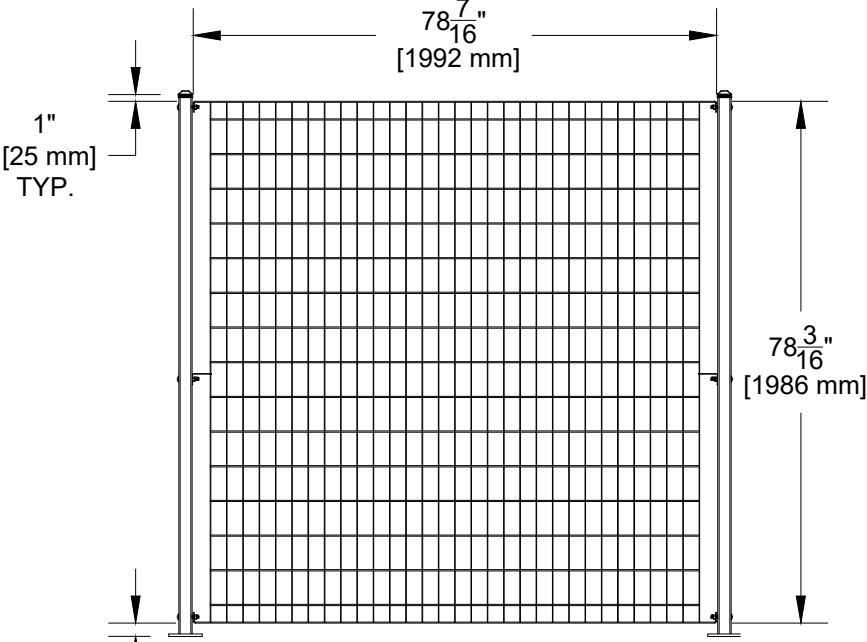

HORIZONTAL WIRES : 6 GA (Ø4.88 mm)
FLAT VERTICAL BARS : 0.08" (2.0 mm) THICKNESS x 1.00" (25.0 mm)
FLAT HORIZONTAL BARS : 0.16" (4.0 mm) THICKNESS x 1.00" (25.0 mm)

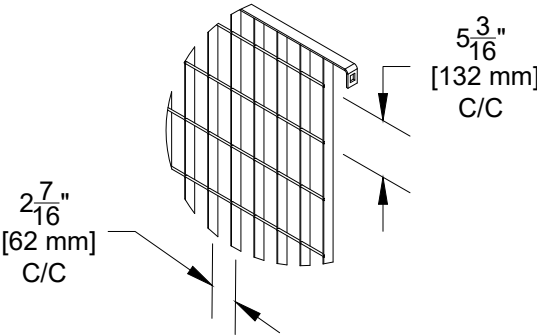

PRODUCT	PRODUCT NUMBER
4' PANEL	C-GB1047BK
6' PANEL	C-GB1078BK
8' PANEL	C-GB1099BK

PANEL HEIGHT	NUMBER OF BOLTS KITS PER POST	NUMBER OF ATTACHMENT PER PANELS (C-GSA)
4' (1.2 m)	2	0
6' (2.0 m)	3	2
8' (2.5 m)	3	2

For further panel information,
Please see specifications,

OMEGA 10 PANEL ON FLAT POST

PANEL 4' (44 lb/ 20 kg)

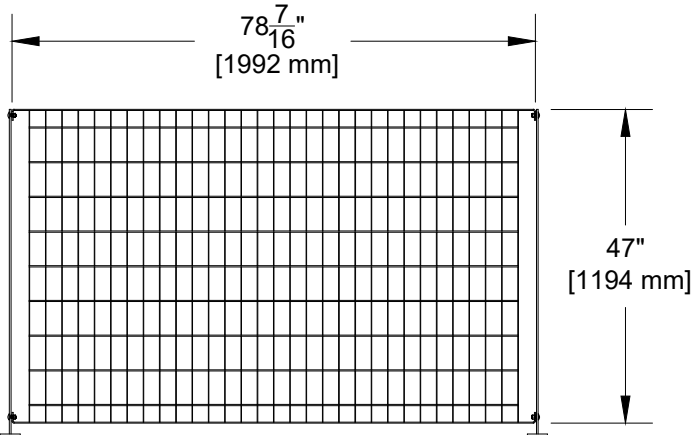

PANEL 8' (85 lb/ 38.6 kg)

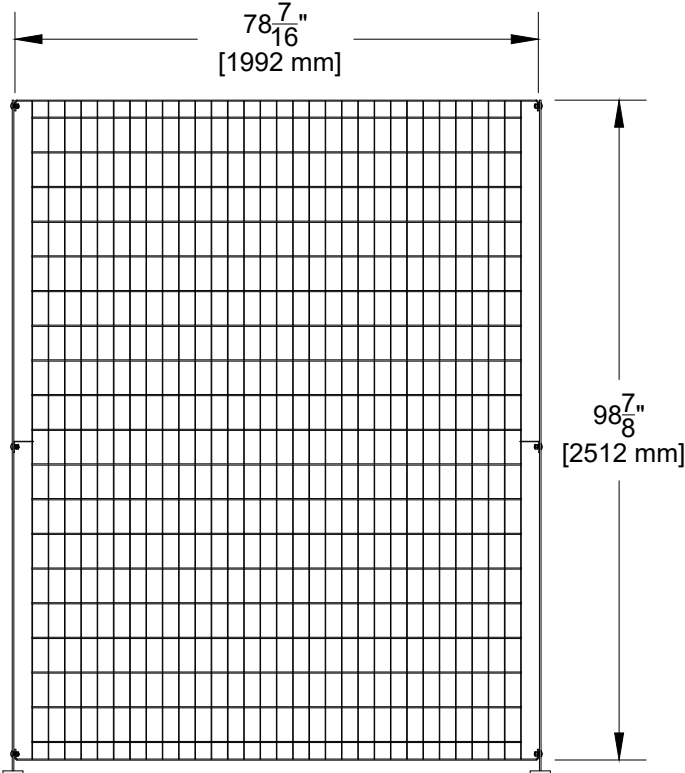

PANEL 6' (68 lb/ 30.8 kg)

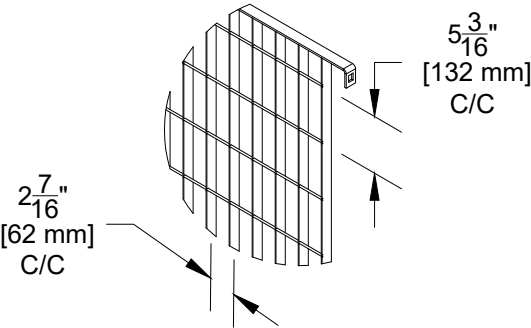
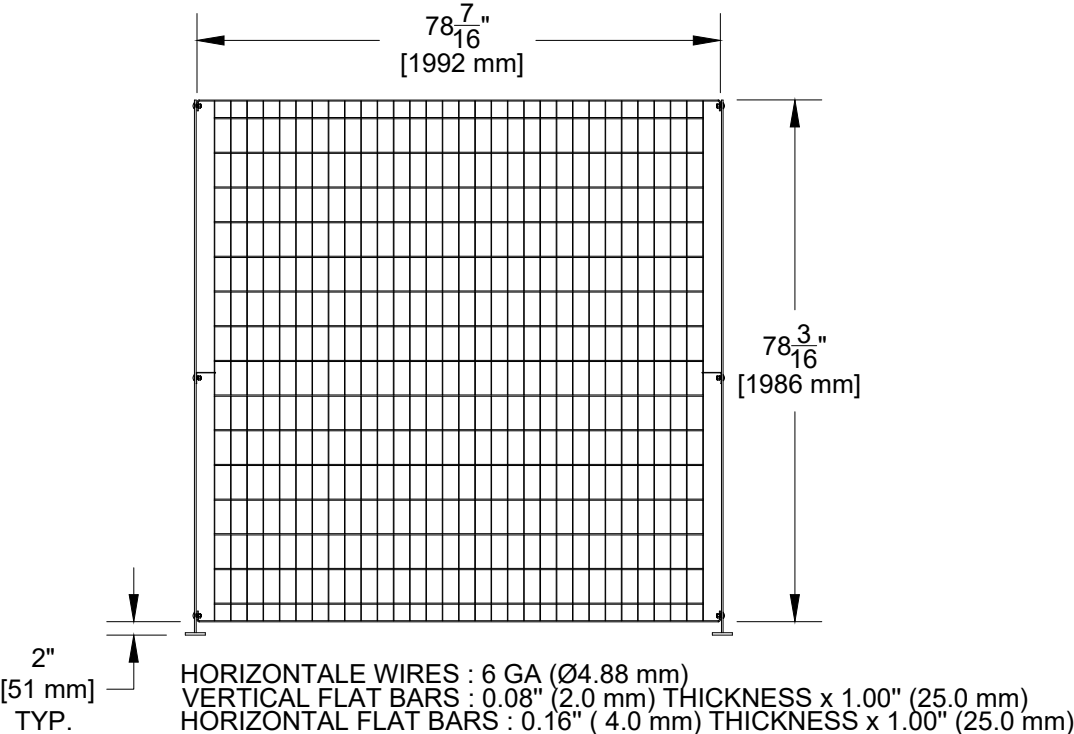

PRODUCT	PRODUCT NUMBER
4' PANEL	C-GB1047BK
6' PANEL	C-GB1078BK
8' PANEL	C-GB1099BK

PANEL HEIGHT	NUMBER OF BOLTS KITS PER POST	NUMBER OF ATTACHMENT PER PANELS (C-GSA)
4' (1.2 m)	2	0
6' (2.0 m)	3	2
8' (2.5 m)	3	2

For further panel information,
Please see specifications.

BRACKET KITS FOR OMEGA 10 PANEL ON SQUARE POST

STANDARD BRACKET
INSTALLATION

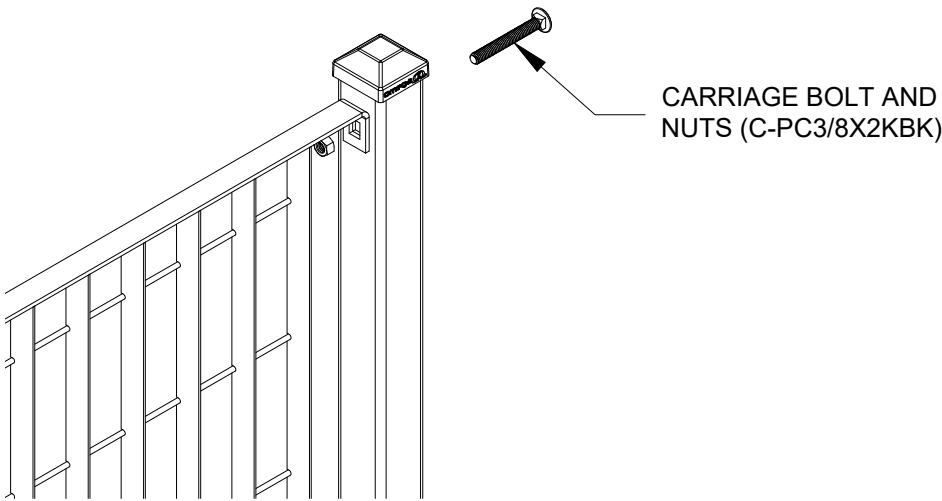

TELESCOPIC BRACKET
INSTALLATION

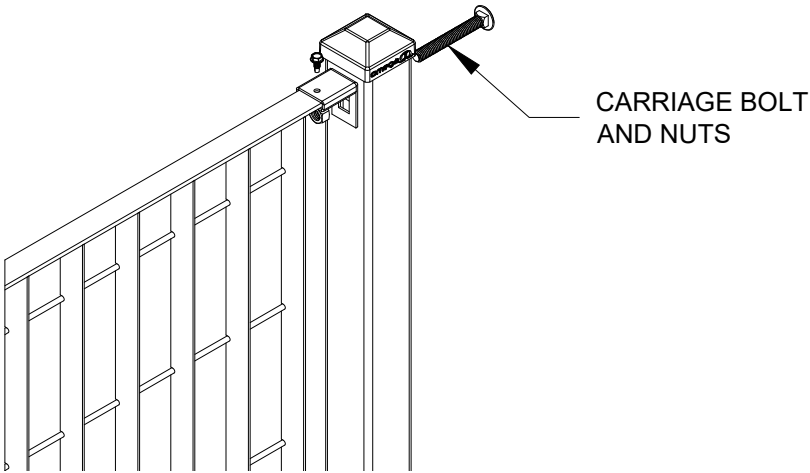

TELESCOPIC
BRACKET

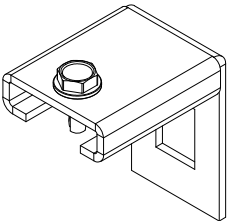

C-GTBK BK

SUPPORT
BRACKET

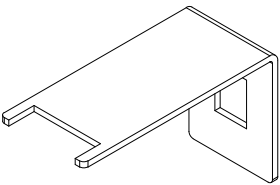

C-GSABK

SUPPORT BRACKET INSTALLATION
78" AND 99" HIGH PANELS

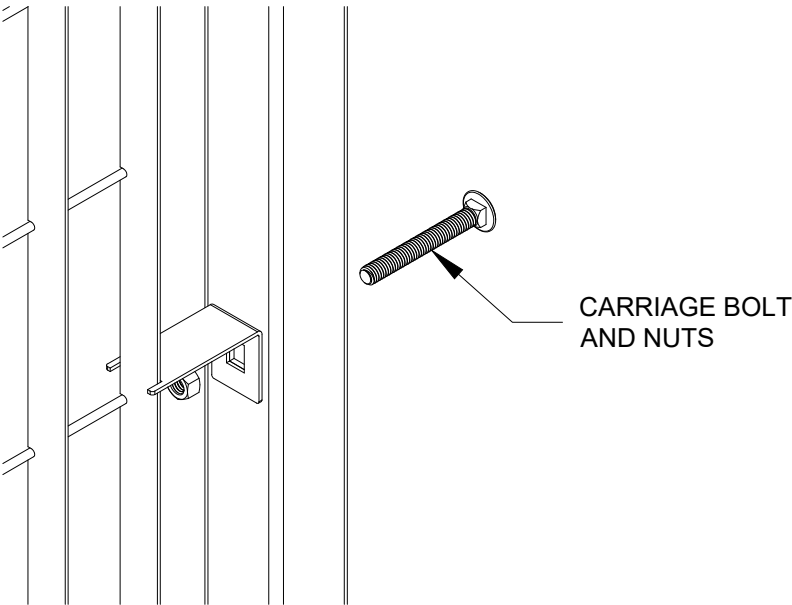

NOTES :
FOR COLORS OTHER THAN BLACK, ALL PARTS ARE
POLYESTER POWDER COATED EXCEPT NUTS & BOLTS.

BRACKET KITS FOR OMEGA 10 PANEL ON FLAT POST

STANDARD BRACKET
INSTALLATION

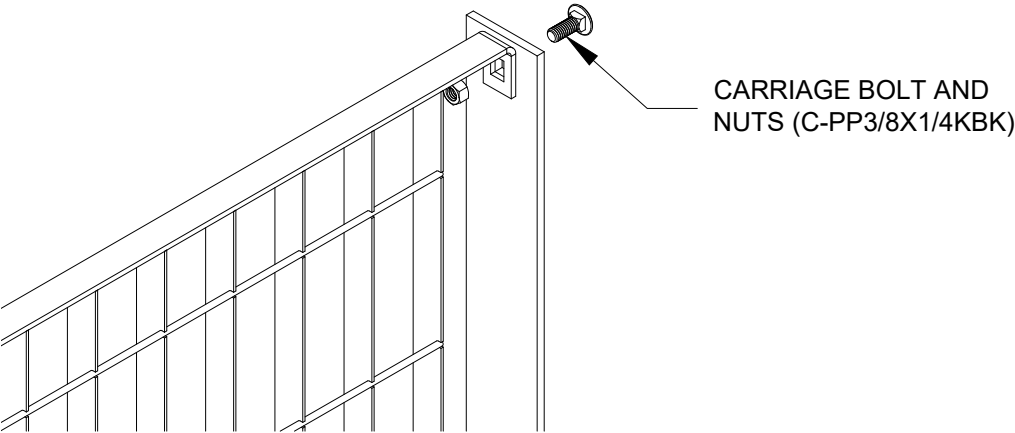

TELESCOPIC BRACKET
INSTALLATION

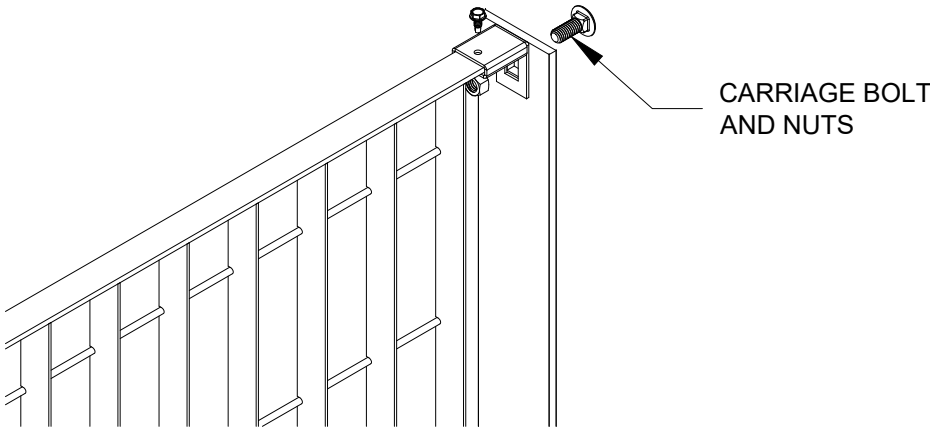

TELESCOPIC
BRACKET

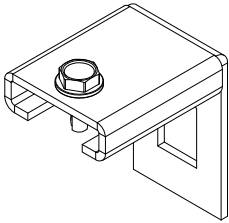

C-GTB

SUPPORT
BRACKET

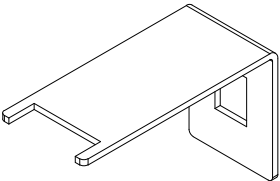

C-GSA

SUPPORT BRACKET INSTALLATION
78" AND 99" HIGH PANELS

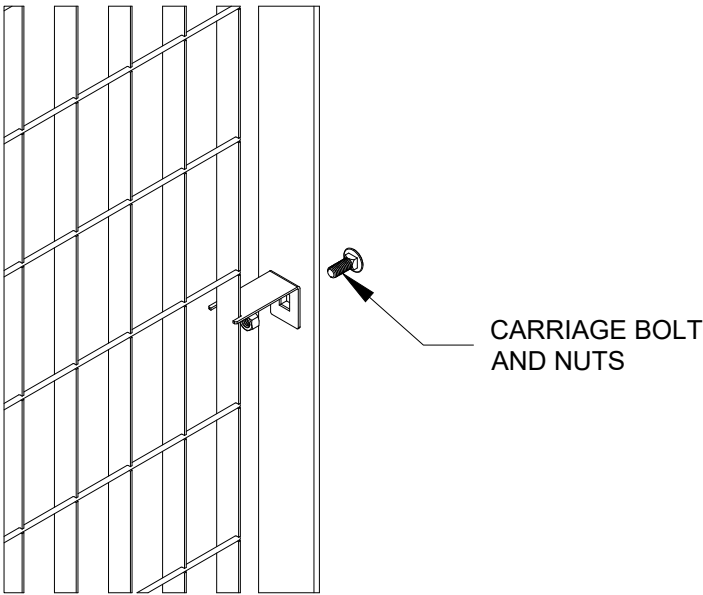

NOTES :
FOR COLORS OTHER THAN BLACK, ALL PARTS ARE
POLYESTER POWDER COATED EXCEPT NUTS & BOLTS.

ANGLE BRACKET KITS FOR OMEGA 10 PANEL

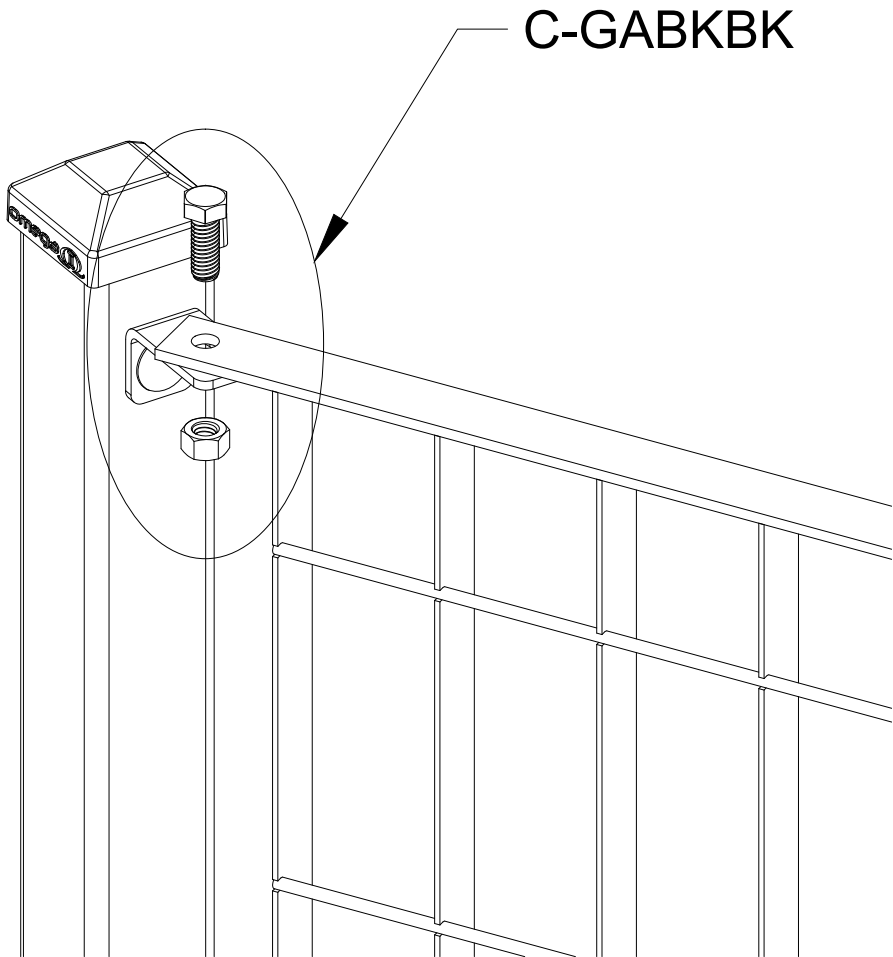
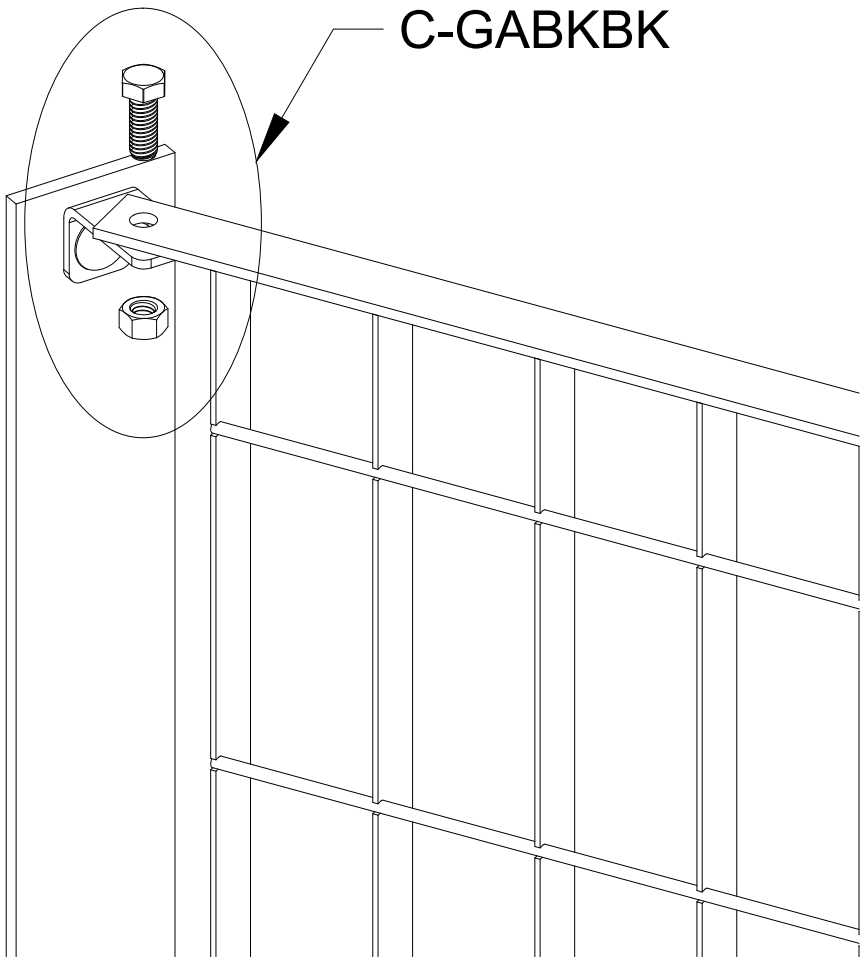

NOTE :
FOR COLORS OTHER THAN BLACK, ALL PARTS ARE
POLYESTER POWDER COATED EXCEPT NUTS & BOLTS.

TELESCOPIC MIDDLE BRACKET FOR OMEGA 10 PANEL

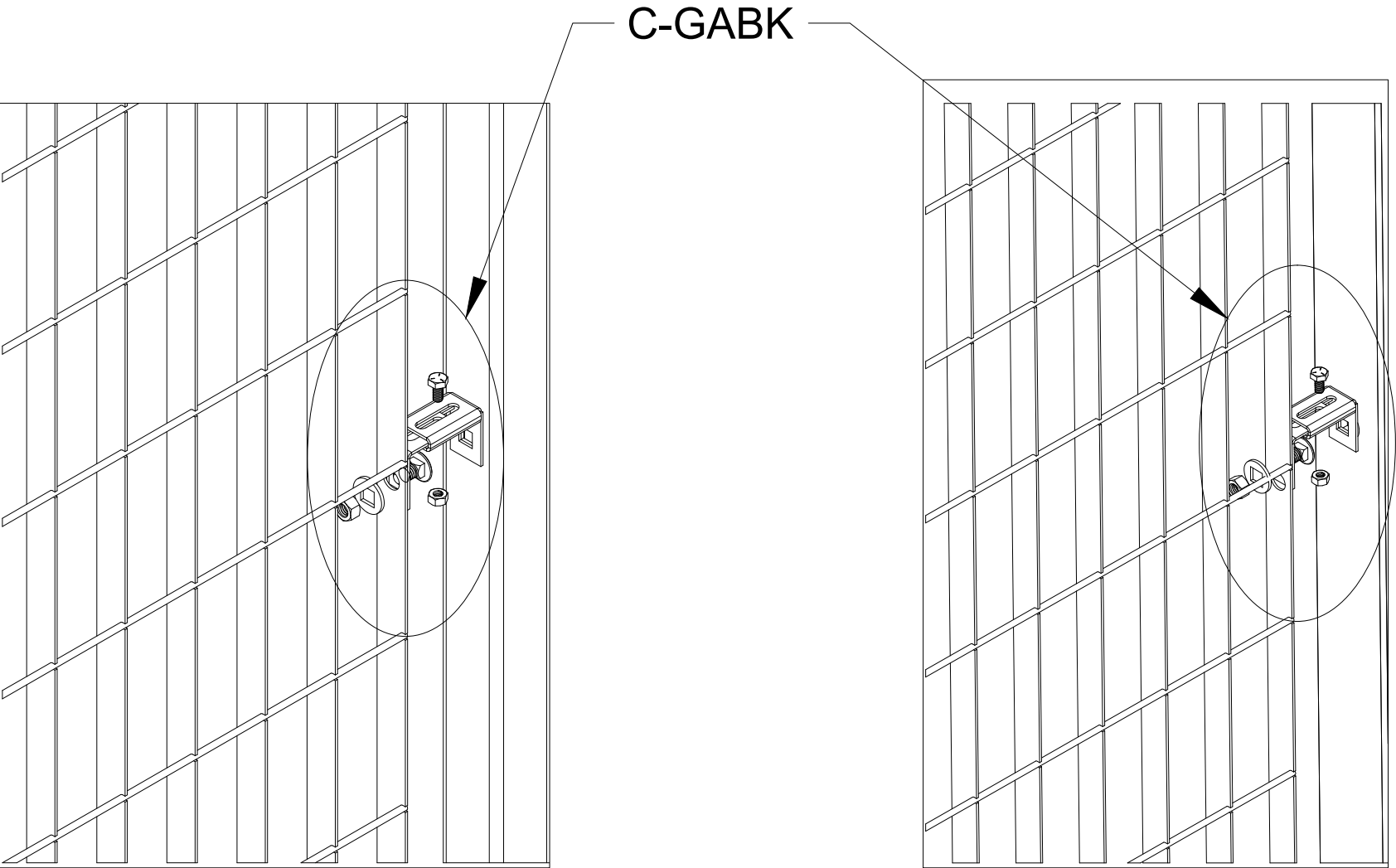

NOTE :
FOR COLORS OTHER THAN BLACK, ALL PARTS ARE POLYESTER POWDER
COATED EXCEPT NUTS & BOLTS.

OMEGA 10 PANEL INSTALLATION ON SQUARE POST

SQUARE POST INSTALLATION WITH STANDARD OR TELESCOPIC BRACKET KIT 14 GA

GRADING

THE GROUND SHALL BE GRADED TO AN EASY EVEN SLOPE ALL ALONG THE LENGTH OF THE AREA WHERE THE FENCE IS TO BE INSTALLED.

INSTALLATION

INSTALL THE FENCE ALONG THE SPECIFIED AREA. THE FENCE SHALL BE INSTALLED AT A DISTANCE OF 2" (50 mm) ABOVE THE GROUND SURFACE. THE RECOMMENDED MINIMUM IS 1" (25 mm) AND MAXIMUM IS 4" (100 mm).

INSTALL ALL THE POSTS VERTICALLY AT PROPER HEIGHT IN CONCRETE. ONCE THE CONCRETE HAS SET AND THE BRACKETS ARE SECURELY ANCHORED, THE PANELS SHALL BE INSTALLED ON 2" (50.8 mm) SQUARE POSTS. THE CENTER TO CENTER DISTANCE HAVE AN ADJUSTMENT OF $\pm \frac{1}{8}$ " (3 mm) ON EACH SIDES. WHEN ANY POST OR WIRE MESH SECTION IS FIELD CUT OR TRIMMED, A ZINC RICH PRIMER MUST BE APPLIED TO THE EXPOSED ENDS. AFTER, AN OMEGA TOUCH-UP PAINT MATCHING THE PROPER COLOR SHALL BE USED.

THE PANELS SHALL BE INSTALLED ACCORDING TO OWNERS INSTRUCTIONS WITH THE FOLLOWING OPTIONS:

- 1) CHOSEN BRACKET MODEL
- 2) PANEL WIRE SIDES FACING INWARDS OR OUTWARDS.

FOR MORE FENCE DETAILS, VISIT OUR WEB SITE'S TECHNICAL PAGE

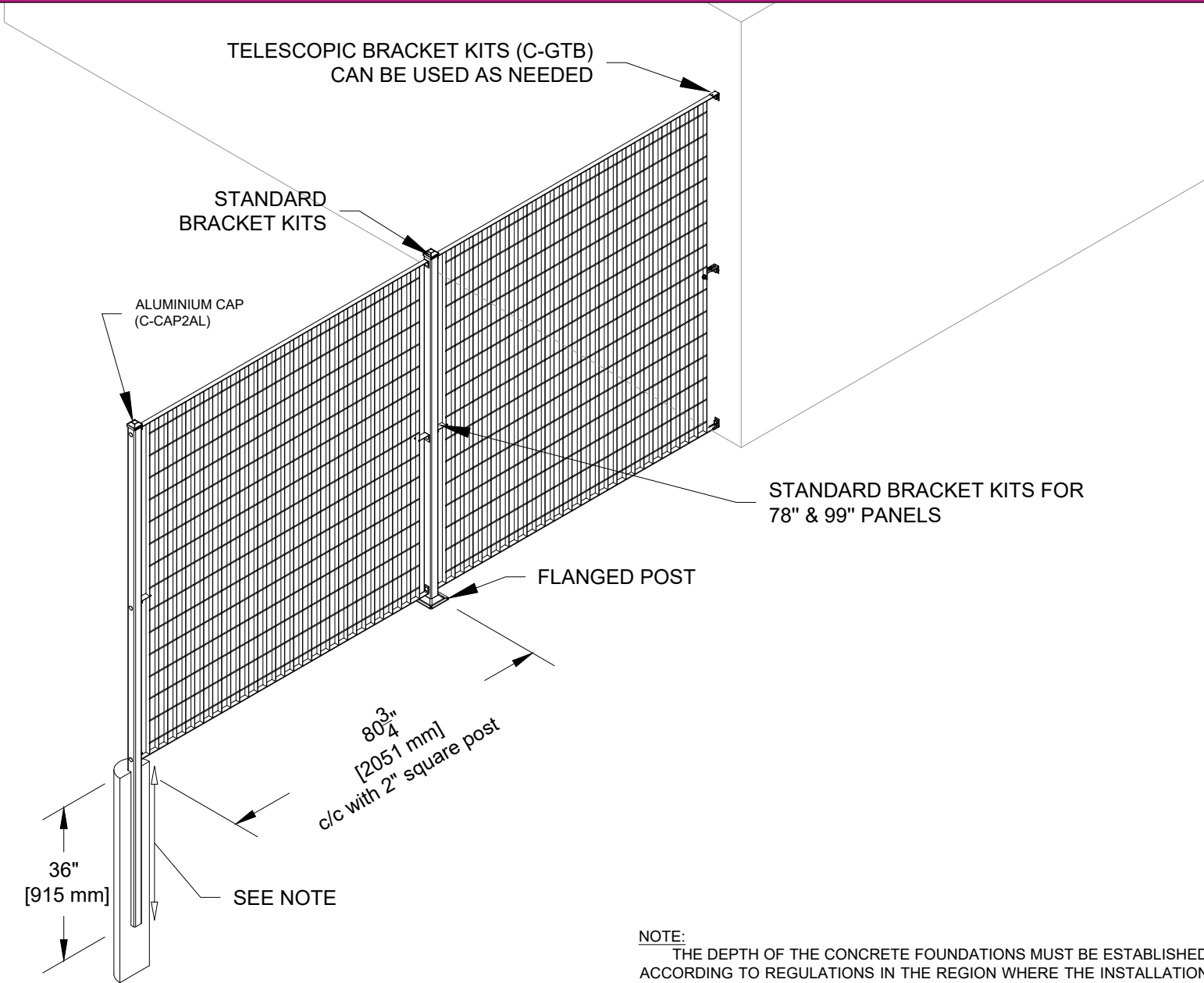

NOTE:
THE DEPTH OF THE CONCRETE FOUNDATIONS MUST BE ESTABLISHED ACCORDING TO REGULATIONS IN THE REGION WHERE THE INSTALLATION IS CARRIED OUT. A MINIMUM DEPTH OF 42 in. (1070 mm) IS RECOMMENDED. THE RECOMMENDED FOUNDATION DIAMETER IS 8 in. (200 mm) FOR A COMMERCIAL SITE AND 6 in. (152 mm) FOR RESIDENTIAL INSTALLATION. REGULATIONS OF THE REGION TAKES PRECEDENCE OVER THE SPECIFICATIONS MENTIONED ABOVE.

OMEGA 10 PANEL INSTALLATION ON FLAT POST

FLAT POST INSTALLATION WITH STANDARD OR TELESCOPIC BRACKET KIT 14 GA

GRADING

THE GROUND SHALL BE GRADED TO AN EASY EVEN SLOPE ALL ALONG THE LENGTH OF THE AREA WHERE THE FENCE IS TO BE INSTALLED.

INSTALLATION

INSTALL THE FENCE ALONG THE SPECIFIED AREA. THE FENCE SHALL BE INSTALLED AT A DISTANCE OF 2" (50 mm) ABOVE THE GROUND SURFACE. THE RECOMMENDED MINIMUM IS 1" (25 mm) AND MAXIMUM IS 4" (100 mm).

INSTALL ALL THE POSTS VERTICALLY AT PROPER HEIGHT IN CONCRETE. ONCE THE CONCRETE HAS SET AND THE BRACKETS ARE SECURELY ANCHORED, THE PANELS SHALL BE INSTALLED ON 2" (50.8 mm) SQUARE POSTS. THE STANDARD BRACKETS SLOT ALLOWS FOR ADJUSTEMENTS OF $\pm\frac{1}{8}$ ". WHEN ANY POST OR WIRE MESH SECTION IS FIELD CUT OR TRIMMED, A ZINC RICH PRIMER MUST BE APPLIED TO THE EXPOSED ENDS. AFTER, AN OMEGA TOUCH-UP PAINT MATCHING THE PROPER COLOR SHALL BE USED.

THE PANELS SHALL BE INSTALLED ACCORDING TO OWNERS INSTRUCTIONS WITH THE FOLLOWING OPTIONS:

- 1) CHOSEN BRACKET MODEL
- 2) PANEL WIRE SIDES FACING INWARDS OR OUTWARDS.

FOR MORE FENCE DETAILS, VISIT OUR WEB SITE'S TECHNICAL PAGE

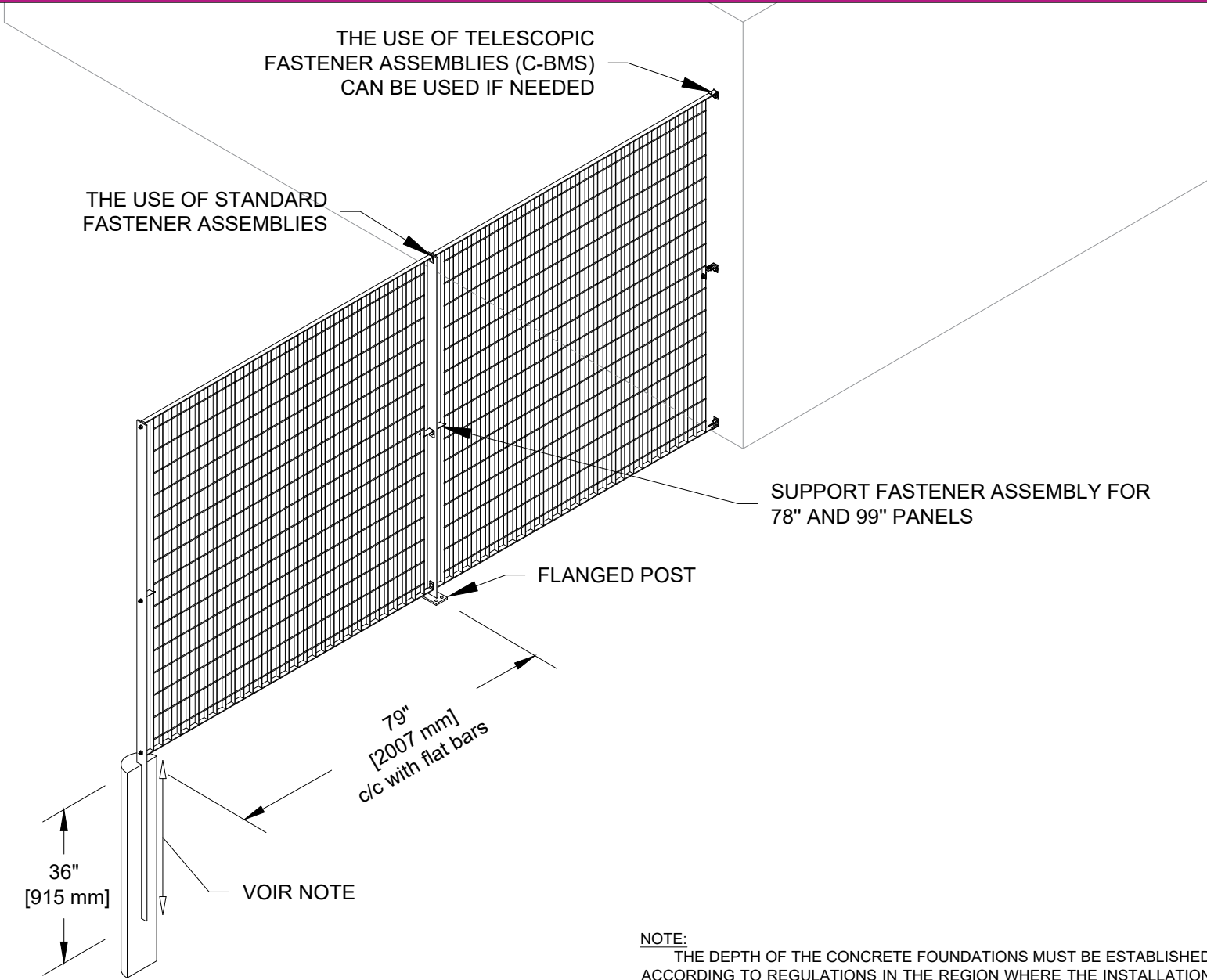

NOTE:
THE DEPTH OF THE CONCRETE FOUNDATIONS MUST BE ESTABLISHED ACCORDING TO REGULATIONS IN THE REGION WHERE THE INSTALLATION IS CARRIED OUT. A MINIMUM DEPTH OF 42 in. (1070 mm) IS RECOMMENDED. THE RECOMMENDED FOUNDATION DIAMETER IS 8 in. (200 mm) FOR A COMMERCIAL SITE AND 6 in. (152 mm) FOR RESIDENTIAL INSTALLATION. REGULATIONS OF THE REGION TAKES PRECEDENCE OVER THE SPECIFICATIONS MENTIONED ABOVE.

OMEGA 10 PANEL INSTALLATION ON SQUARE POST SLOPED GROUND

NON-STANDARD POST FOR STEPPED
SLOPE (ON DEMAND)

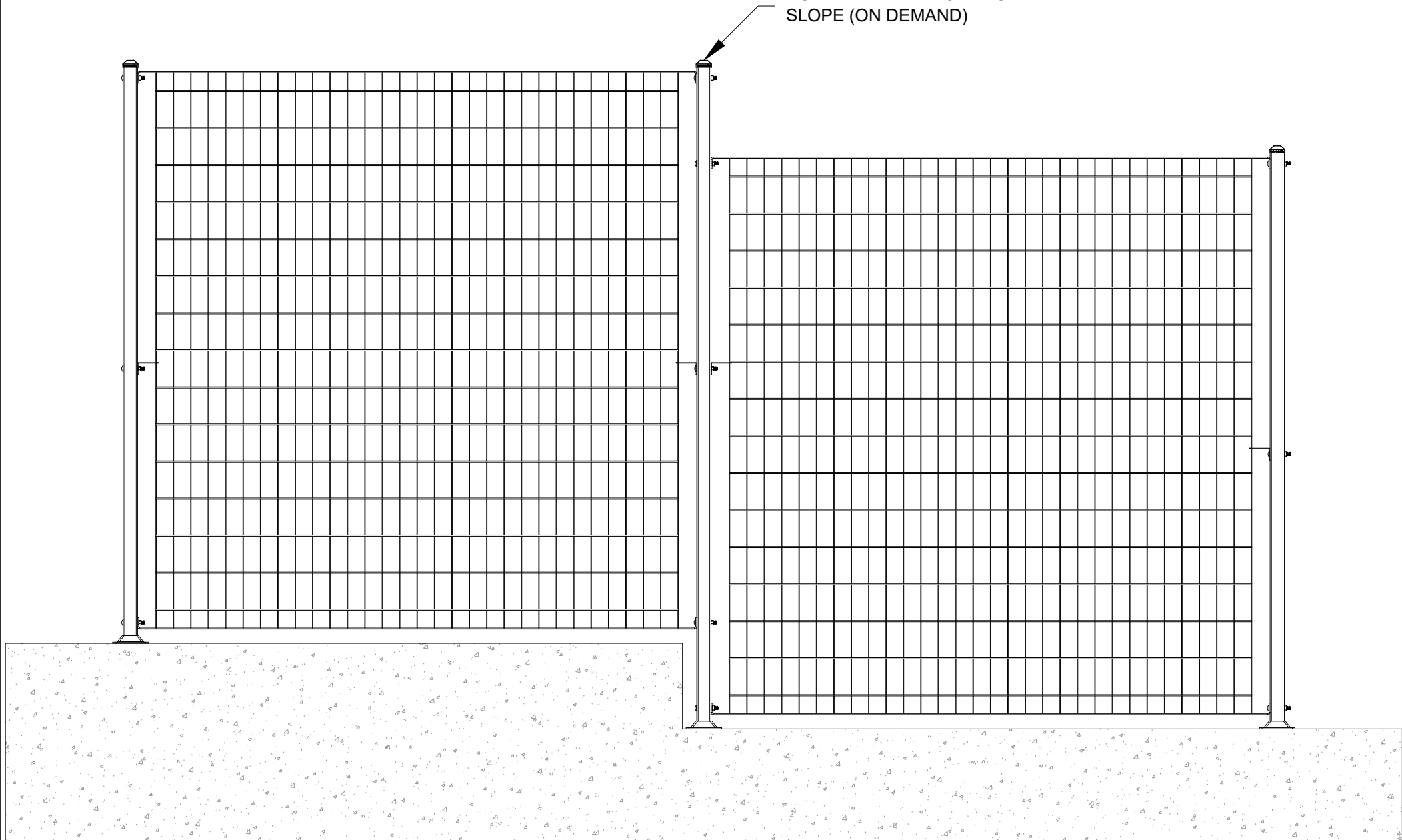

OMEGA 10 PANEL INSTALLATION ON FLAT POST SLOPED GROUND

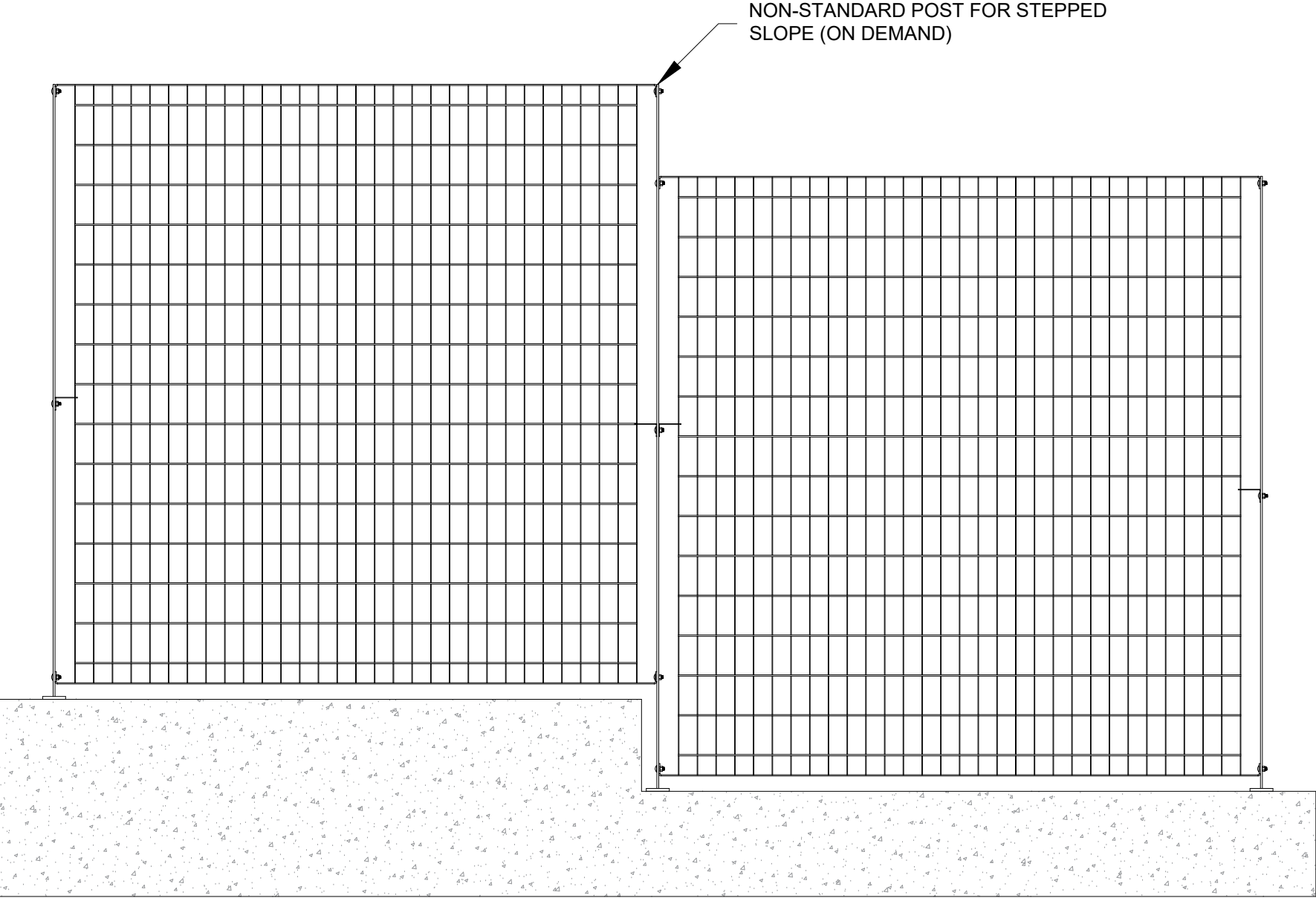

OMEGA 10 SINGLE SWING GATE GPG10

C-GPG10XX48

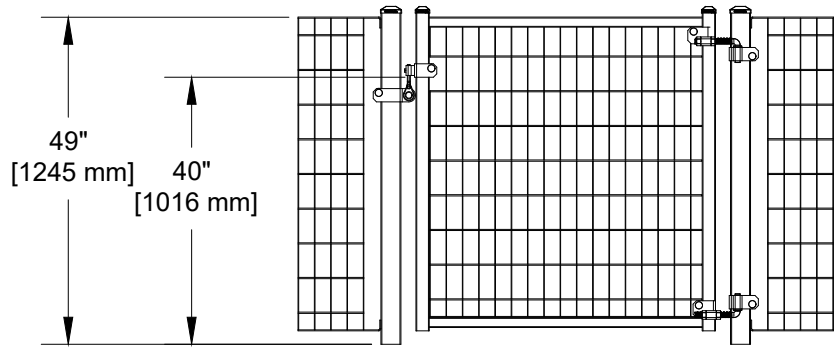

C-GPG10XX78

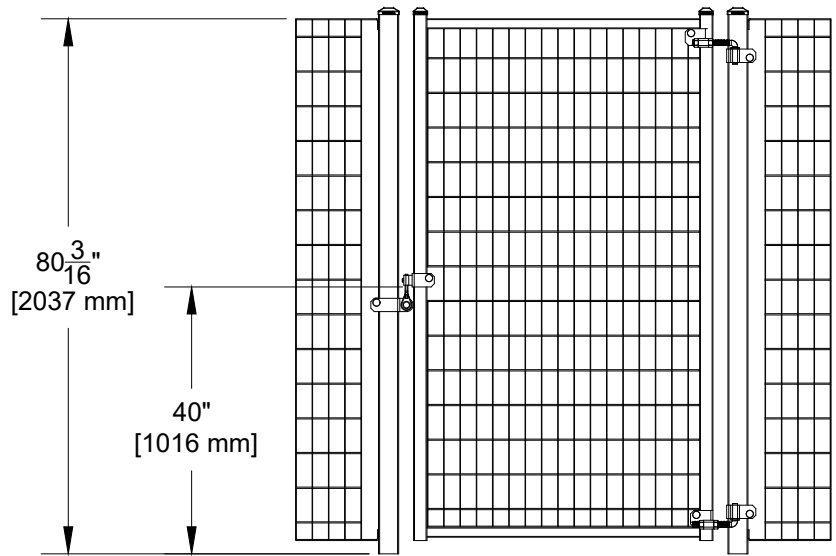

C-GPG10XX99

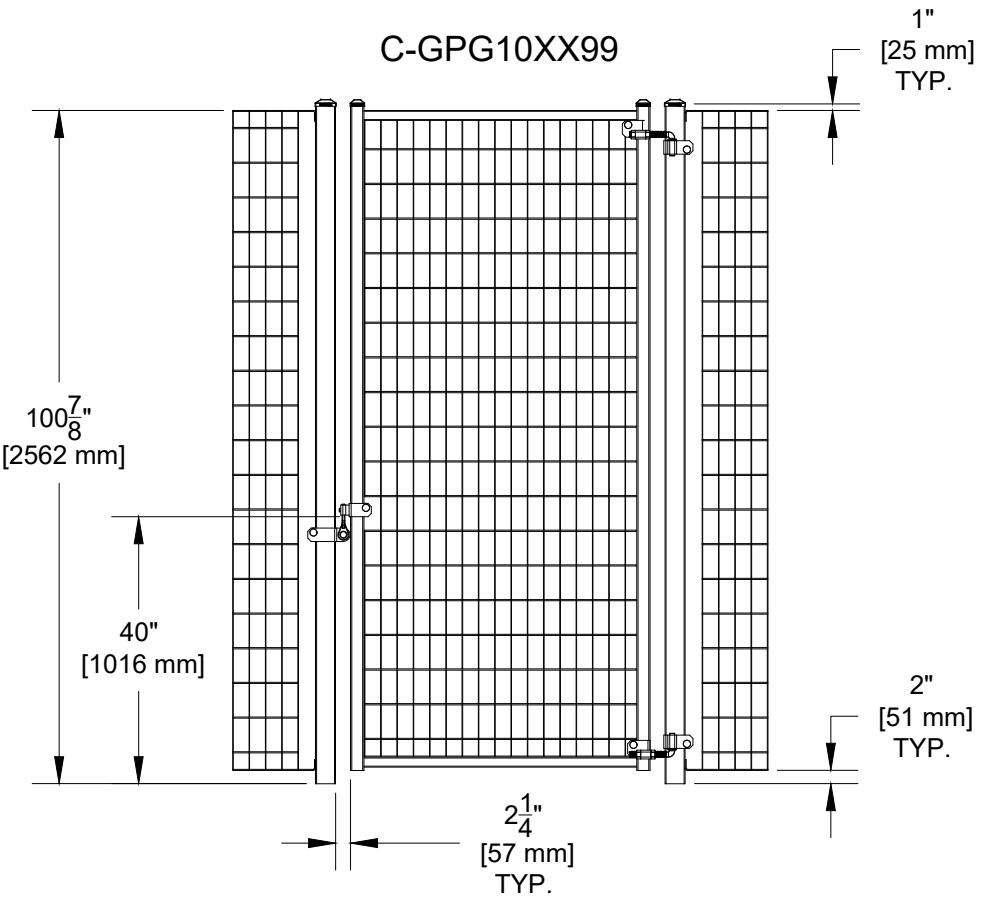

SURFACE FINISH
ALL OMEGA 10 GATES ARE COATED WITH POLYESTER POWDER COATING.
FOR MORE INFORMATION, PLEASE REFER TO SPECIFICATIONS.



Omega II Fence Systems
1735, Blvd. St-Elzéar West
Laval, Quebec
H7L 3N6
Tel: 450-686-9600
1-800-836-6342
Fax: 450-681-5318
www.omegafence.com

GB10-11
REVISION : 03/22

OMEGA 10 SINGLE & DOUBLE SWING GATE MODEL GPG10

SECTION B-B
FRAME & PANEL

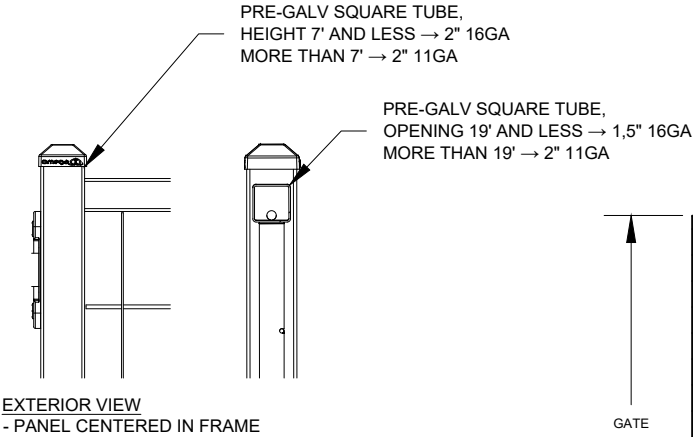

Omega 10			
Panel	Minimum opening*	Maximum opening*	Post
4'-0"	3'	9'	3" x 3" 11 ga
	>9'	14'	4" x 4" 11ga
	>14'	19'	6" x 6" 3/16"
6'-0"	3'	8'	3" x 3" 11 ga
	>8'	10'	4" x 4" 11ga
	>10'	19'	6" x 6" 3/16"
8'-0"	3'	6'	3" x 3" 11 ga
	>6'	8'	4" x 4" 11ga
	>8'	19'	6" x 6" 3/16"

*ALL OPENING ARE BASED ON THE SIMPLE DOOR MODEL

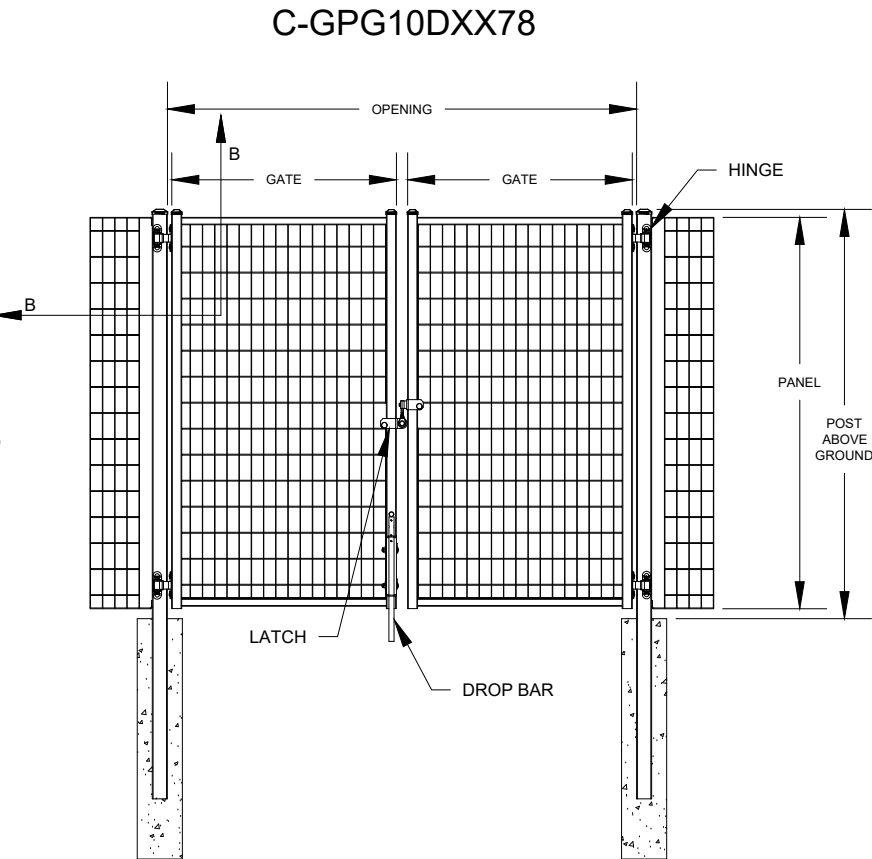
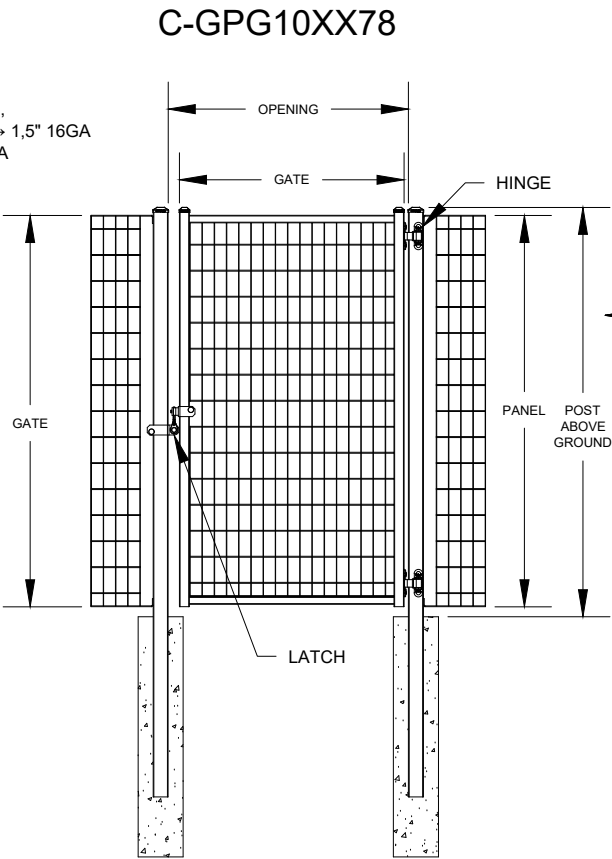

HINGES AND LATCHES CAN BE
INSTALLED ON EITHER SIDE

NOTE:
THE DEPTH OF THE CONCRETE FOUNDATIONS MUST BE ESTABLISHED ACCORDING TO REGULATIONS IN THE REGION WHERE THE INSTALLATION IS CARRIED OUT. A MINIMUM DEPTH OF 42 in. (1070 mm) IS RECOMMENDED. THE RECOMMENDED FOUNDATION DIAMETER IS 8 in. (200 mm) FOR A COMMERCIAL SITE AND 6 in. (152 mm). FOR RESIDENTIAL INSTALLATION, REGULATIONS OF THE REGION TAKES PRECEDENCE OVER THE SPECIFICATIONS MENTIONNED ABOVE.

OMEGA 10 CANTILEVER SLIDE ALUMINUM GATE

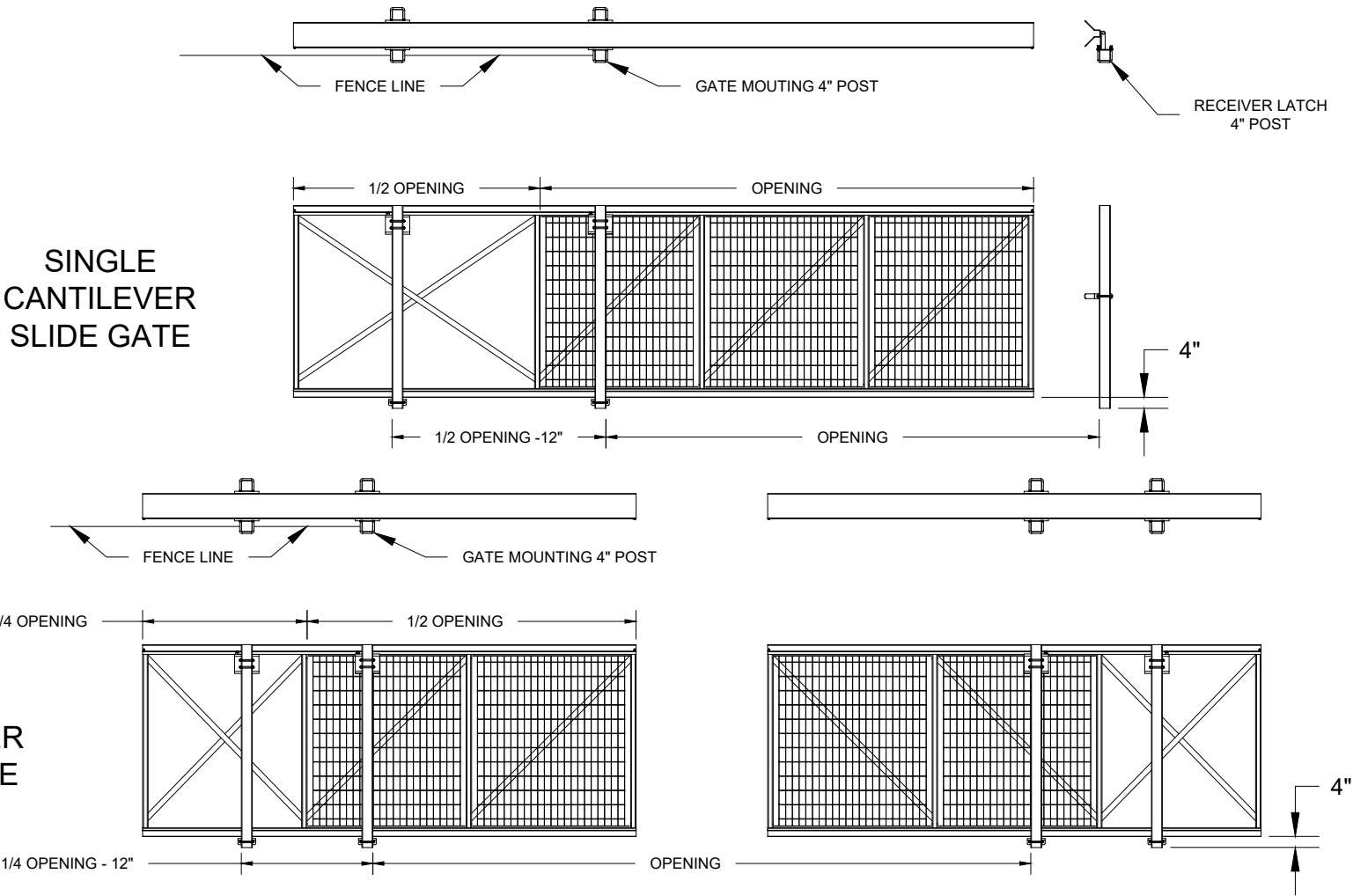

TUBE BRACED CANTILEVER SLIDE:

THE ALUMINUM CANTILEVER GATES ARE CONSTRUCTED WITH AN UPPER AND LOWER TRACK, FABRICATED FROM OF 6061-T6 ALUMINIUM ALLOY EXTRUSIONS. THE UPPER AND LOWER TRACKS SHALL BE WELDED AND/OR BOLTED TO 2"x2"x.125". EACH FRONT SECTION SHALL HAVE ONE DIAGONAL BRACE OF 1"x2"x.125 WALL ALUMINIUM TUBE. EACH TAIL SECTION OF THE GATE SHALL BE X-BRACED WITH TWO 1"x2"x.125 WALL ALUMINIUM TUBE. OUR STANDARD COLORS UTILIZED AN PAINT PRIMER WITH AN ACRYLIC SURFACE COATING. BOTH COATINGS ARE APPLIED IN ONE LAYER BY SPRAY PAINT PROCESS. THE FABRIC SHALL BE HELD IN PLACE BY CARRIAGE BOLTS & NUTS.. GATES WITH BARBWIRE SHALL USE BRACE BANDS AND BOLTS TO HOLD THE WIRE IN PLACE. ALUMINUM CANTILEVER GATES ARE AVAILABLE IN ALUMINUM ONLY AND CAN BE ORDERED AS MODULAR/KNOCK-DOWN GATES, IDEAL FOR TRANSPORTING TALL GATES. THESE COME READY TO ASSEMBLE WITH ALL HOLES PREDRILLED FOR 1/2" BOLTS, WHICH ARE SUPPLIED FOR ASSEMBLY.

GATE POSTS:

THE 4" POSTS ARE MADE OF GALVANIZED STEEL. PROVIDE 1 LATCH POST AND 2 SUPPORT POSTS FOR SINGLE SLIDE GATE AND 4 SUPPORT POSTS FOR DOUBLE SLIDE GATES.



Omega II Fence Systems
1735, Blvd. St-Elzéar West
Laval, Quebec
H7L 3N6

Tel: 450-686-9600
1-800-836-6342
Fax: 450-681-5318
www.omegafence.com

GB10-13

REVISION : 11/21

OMEGA 10 CANTILEVER SLIDE ALUMINUM GATE CUSTOM SIZES

CANTILEVER DOUBLE SLIDE
GATE OVER 8' HIGH

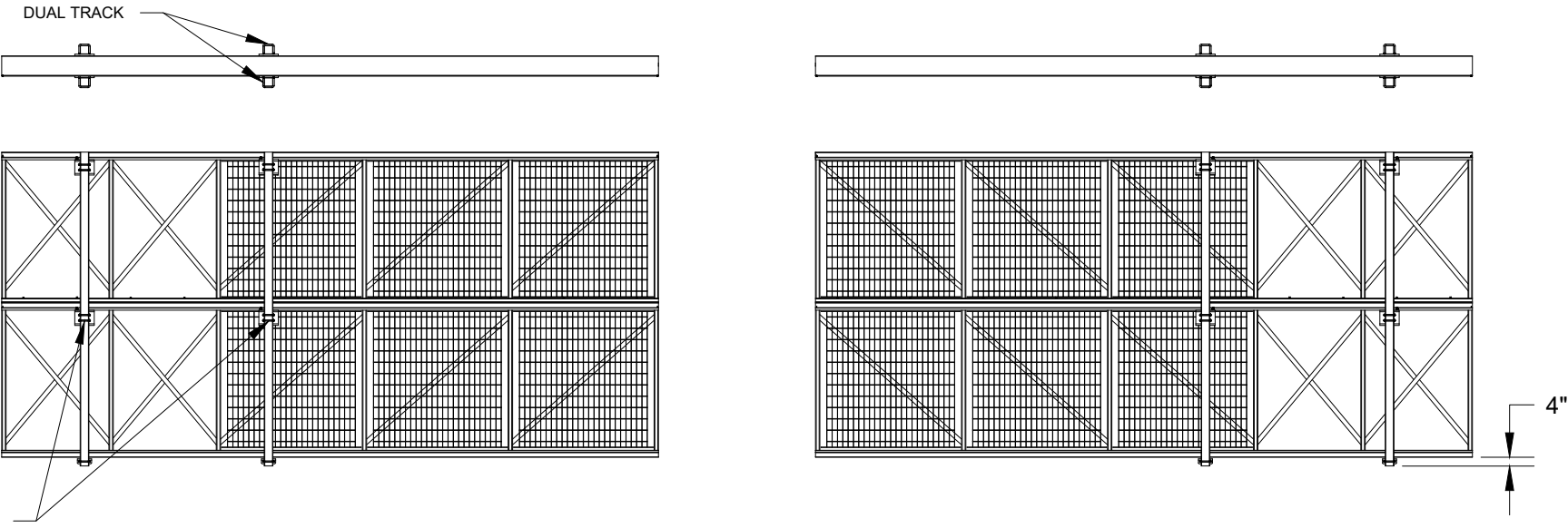

CANTILEVER SLIDE GATE
OVER 360" OPENING

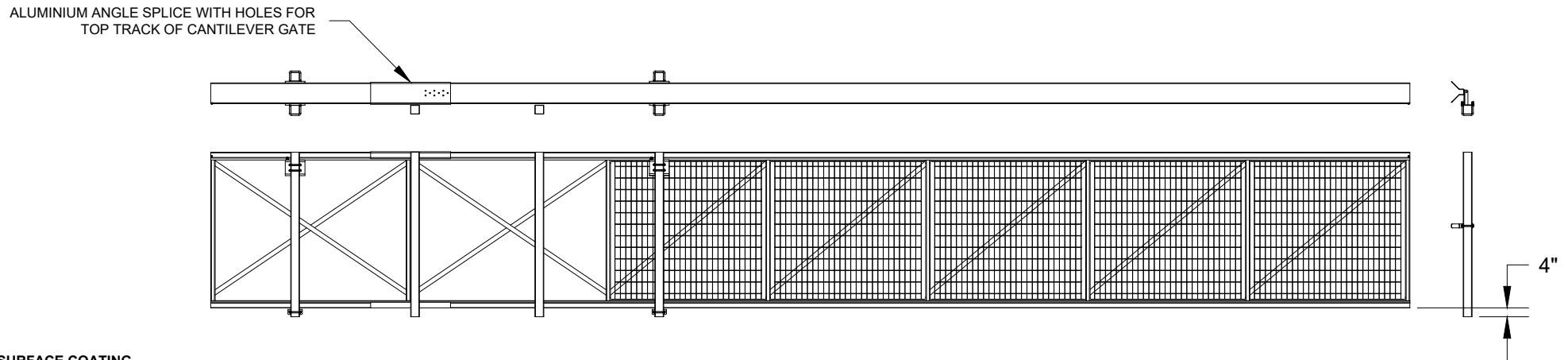

SURFACE COATING

ALL GATES HAVE A PAINT PRIMER APPLIED TO THE FRAME. AFTERWARDS AN ACRYLIC SURFACE COATING (STANDARD BLACK OR ANY OPTIONAL COLOR) IS APPLIED IN ONE LAYER BY SPRAY PAINT PROCESS. POLYESTER COATING IS APPLIED BY AN ELECTROSTATIC METHOD AND AVAILABLE IN SEVERAL COLORS. FOR MORE INFORMATION, PLEASE REFER TO SPECIFICATIONS.